



## Surface mounting components: Mono 9/125 SC optic fibre adapter

### 03100.SC

System infrastructure / Netsafe structured wiring / Surface mounting components / FTTH

### Mono 9/125 SC optic fibre adapter

SC/APC single-mode adapter, 9/125 µm, for 03124.SC.E patch panels

### Product Status

3 - Active

### Minimum order quantity

6 NR



## Drawings

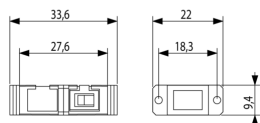

Space view

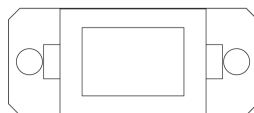

Backside view

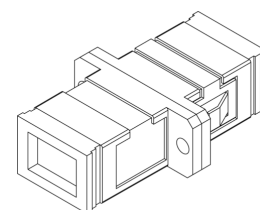

3D View

## Technical data

- **Class group:** Installation, isolation and connection material
- **Class:** Cable end sleeve
- **Construction type:** Standard
- **Sleeve length:** 33,60 mm
- **Insulated:** Yes
- **Material insulation:** Other
- **Halogen free:** Yes
- **Colour:** Other
- **Material:** Other
- **Surface protection:** Other
- **For cables resistant to short circuit:** No
- **With identification flag:** No
- **Reel/roll packaging:** No

# Packaging



**Code** 8007352559523  
**Quantity** 1 NR  
**Dim.** 3.3x2.2x0.9 [cm]  
**Weight** 4.4 [g]



**Code** 8007352559530  
**Quantity** 6 NR  
**Dim.** 12x10x2 [cm]  
**Weight** 27.5 [g]



**Code** 8007352559547  
**Quantity** 60 NR  
**Dim.** 18.8x13.8x7 [cm]  
**Weight** 334.3 [g]

# Legal

Vimar reserves the right to change at any time and without notice the characteristics of the products reported. Installation should be carried out by qualified staff in compliance with the current regulations regarding the installation of electrical equipment in the country where the products are installed. For the terms of use of the information on the product info sheet see [Conditions of Use](#).